

# MOELLER

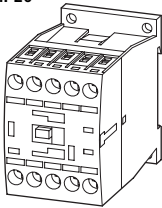

ALPHA LOVAG

**DILA(C)  
DILM(C)7...M(C)15  
DILMP20**



**DILM32-XHI(C)...  
DILA-XHI(C)...**

Hilfsschalterbaustein  
Auxiliary contact module  
Module de contacts auxiliaires  
Modulo contatti ausiliari  
Módulo de contactos auxiliares  
Модуль вспомогательных выключателей  
辅助开关组

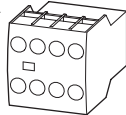

- |                    |                     |                       |                   |      |
|--------------------|---------------------|-----------------------|-------------------|------|
| <b>Montage</b>     | ① aufsetzen         | ① place in position   | ① mettre en place | ① 装配 |
| <b>Mounting</b>    | ② rasten            | ② latch in            | ② encliqueter     | ② 装上 |
| <b>Montage</b>     | ① appoggiare        | ① colocar en posición | ① осадить         | ① 嵌入 |
| <b>Montaggio</b>   | ② inserire a scatto | ② enclavar            | ② зафиксировать   | ② 嵌入 |
| <b>Montaje</b>     |                     |                       |                   |      |
| <b>Montage</b>     |                     |                       |                   |      |
| <b>Разборка</b>    |                     |                       |                   |      |
| <b>拆卸</b>          |                     |                       |                   |      |
| <b>Demontage</b>   | ③ schieben          | ③ push                | ③ pousser         | ③ 推  |
| <b>Dismantling</b> | ④ abziehen          | ④ remove              | ④ retirer         | ④ 拔出 |
| <b>Démontage</b>   | ③ insérer           | ③ desplazar           | ③ задвинуть       | ③ 推  |
| <b>Smontaggio</b>  | ④ estrarre          | ④ extraer             | ④ снять           | ④ 拔出 |
| <b>Desmontaje</b>  |                     |                       |                   |      |
| <b>Разборка</b>    |                     |                       |                   |      |
| <b>拆卸</b>          |                     |                       |                   |      |

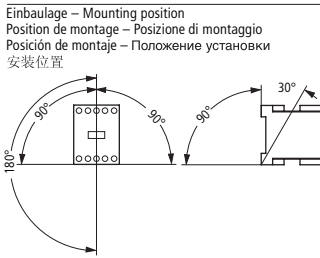
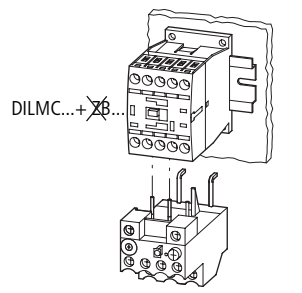
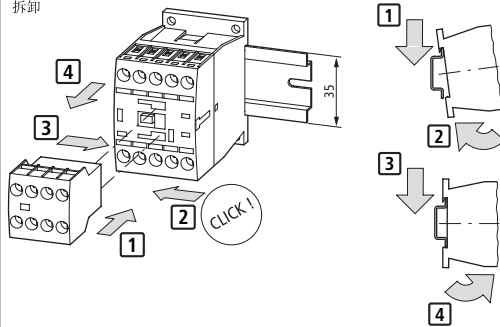

08/06 AWA2100-2126  
**Montageanweisung**  
**Installation Instructions**  
**Notice d'installation**  
**Istruzioni per il montaggio**  
**Инструкция по монтажу**  
**安装说明**

**DILM...**

	mm <sup>2</sup>	AWG	Nm	lb-in
	1 × (0.75 - 4)	18 - 10	1.2	11
	2 × (0.75 - 2.5)			
	1 × (0.75 - 2.5)			
	2 × (0.75 - 2.5)			
	-			

  

**DILM...**

	mm <sup>2</sup>	
	1 × (0.75 - 2.5)	1 × (0.75 - 2.5)
	2 × (0.75 - 2.5)	2 × (0.75 - 2.5)
	1 × (0.75 - 2.5)	
	2 × (0.75 - 2.5)	

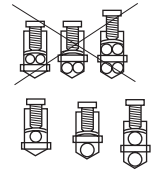

**DILM(C)7...M(C)15  
DILMP20**

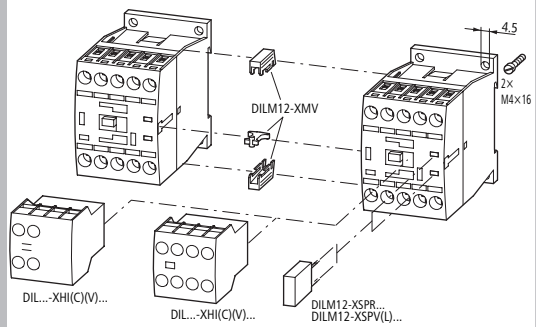
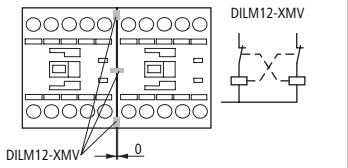

Moeller GmbH, Industrieautomation,  
D-53105 Bonn©2004 by Moeller GmbH

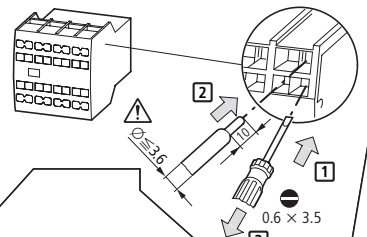

**Warning!**  
 The opening of the branch-circuit protective device may be an indication that a fault has been interrupted. To reduce the risk of fire or electrical shock, current-carrying parts and other components of the controller should be examined and replaced if damaged. If burnout of the element of an overload relay occurs, the complete overload relay must be replaced.

For Immediate Delivery call [KMParts.com](http://KMParts.com) at (866) 595-9616

08/06 AWA2100-2126 DE03 DokU  
 Printed in Germany (09/06)  
 Änderungen vorbehalten